

Flat

Design by Ichiro Iwasaki.

Reference

5924.

Application

Ceiling Fixtures

Installation type

Surface mounted

Description

Flat lamps are a creation from the designer Ichiro Iwasaki. The discs of light descend from the ceiling to form a hanging lamp, where the planes of reflected light blend in with the architecture. All the models in the Flat collection incorporate LED lighting and are available in a range of neutral color tones.

Diffuser

Polycarbonate diffuser

Materials

Canopy: Steel
Reflector: Aluminum
Body: Steel

Finishes

5924-10 White (NCS S 0300-N)

5924-72 White, Green L1 (NCS S 0300-N, NCS S 4005-G80Y)

5924-73 White, Grey L1 (NCS S 0300-N, NCS S 1000-N)

Sketch

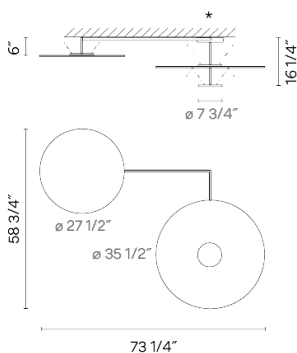

Electrical characteristics

3 x LED PLATE 20W 700mA

Total 60.0 W



VIBIA



Light source: 2700K CRI >90 8700 lm 145 lm/W

Driver included: CC - Constant Current 700 mA 120~277V 50/60Hz

Electronic dimming: 0-10V

Optional dimming: DALI or TRIAC

Installation and assembly

Please see the installation manual

Light distribution

Indirect lighting

Lamp that emits an upward or backward beam that is reflected by the ceiling or wall.

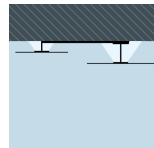

Photometric data

Certificates

