



Santorini Sputnik Studio

marset

Inspired by the lanterns found on fishing boats, this collection of outdoor customizable lamps allows you to create multiple compositions. Users can choose

how many shades to place on the diffuser, along with their order, position and direction. This interplay of combinations yields a rich array of direct or reflected light.



Santorini

- | | |
|----------|----------------------|
| Code | Finish |
| A654-011 | ● White (RAL 9003) |
| A654-012 | ● Grey (RAL 7039) |
| A654-013 | ● Mustard (RAL 1032) |

Socket: E26
 Suggested lamping: LED TYPE A19, 8W max
 Lamping not included

Dimmable: Based on specified lamping
 Integrated dimmer: No
 Dimming protocols: Based on specified lamping
 Supply voltage: 120V

Materials
 Structure: Polycarbonate
 Shade: Blown pressed glass

Suitable for wet locations

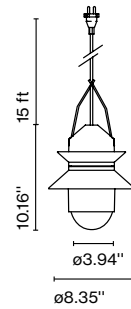

Garland accessory

Code A654-045
 Finish ● Grey

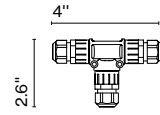

Wall bracket

Code A654-005
 Finish ● Graphite grey (RAL 7024)

Materials
 Structure: Metal with stainless anti-oxidant cataphoresis treatment

Suitable for wet locations

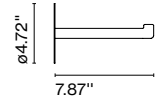

Floor accessory

Code A654-009
 Finish ● Grey (RAL 7039)

Materials
 Structure: Metallic structure with stainless anti-oxidant cataphoresis treatment

Suitable for wet locations

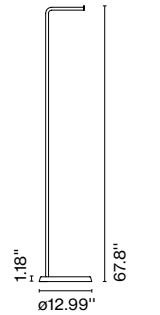

Santorini A Fixed Stem

Code	Finish
A654-030	● White (RAL 9003)
A654-031	● Grey (RAL 7039)
A654-032	● Mustard (RAL 1032)

Socket: E26
Suggested lamping: LED TYPE A19, 8W max
Lamping not included

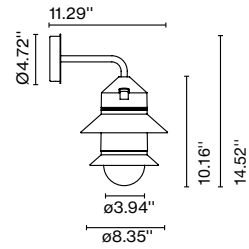

Dimmable: Based on specified lamping
Integrated dimmer: No
Dimming protocols: Based on specified lamping
Supply voltage: 120V

Materials
Structure: Polycarbonate
Shade: Blown pressed glass
Support: Stainless anti-oxidant cataphoresis treatment

Suitable for wet locations

**Santorini C**

Code	Finish
A654-033	● White (RAL 9003)
A654-034	● Grey (RAL 7039)
A654-035	● Mustard (RAL 1032)

Socket: E26
Suggested lamping: LED TYPE A19, 8W max
Lamping not included

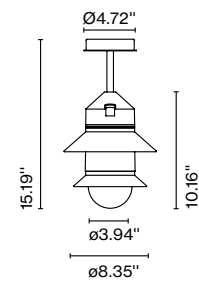

Dimmable: Based on specified lamping
Integrated dimmer: No
Dimming protocols: Based on specified lamping
Supply voltage: 120V

Materials
Structure: Polycarbonate
Shade: Blown pressed glass
Support: Stainless anti-oxidant cataphoresis treatment

Suitable for wet locations

**Santorini with Canopy IP65**

Code	Finish
A654-039	● White (RAL 9003)
A654-040	● Grey (RAL 7039)
A654-041	● Mustard (RAL 1032)

Socket: E26
Suggested lamping: LED TYPE A19, 8W max
Lamping not included

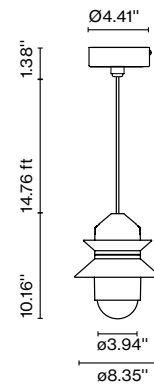

Dimmable: Based on specified lamping
Integrated dimmer: No
Dimming protocols: Based on specified lamping
Supply Voltage: 120V

Materials
Structure: Polycarbonate
Shade: Blown pressed glass
Support: Stainless anti-oxidant cataphoresis treatment

Suitable for wet locations



⚠ WARNING. California Proposition 65 Warning for California Consumers. This product can expose you to chemicals including wood dust and lead which are known to the State of California to cause cancer or birth defects or other reproductive harm. For more information go to www.P65Warnings.ca.gov

marsetusa@marset.com
www.marset.com

Download

Photometric data file (LDT or IES)
2D, 3D, Photometric Data
Assembly instructions

Collection

